

CITY OF COURTENAY CEMETERY FEES EXPLANATION OF RESIDENTS & NON-RESIDENT RATES

You will notice within the fee schedule on the following pages, reference to “RESIDENT FEES” and “NON-RESIDENT FEES”.

The City of Courtenay “Cemetery Management Bylaw No. 2569, 2009”, defines “Non-Resident” as follows:

“Non-Resident” means any person who does not live within the municipal limits of the City of Courtenay, Town of Comox or within boundaries of Electoral Area ‘B’, Comox Valley Regional District, except that a person who at the time of death was the owner as defined in the Municipal Act of Real Property within the City of Courtenay, Town of Comox, or the Electoral Area ‘B’ of the Comox Valley Regional District would for the purposes of this bylaw be considered a resident.

The City owns and operates the cemetery however, capital funds are also received from the Town of Comox and Electoral Area ‘B’, Comox Valley Regional District that are put towards the cemetery function which pays for capital items such as irrigation upgrades, new niche walls, fencing, development of new sections, new garbage receptacles, plantings, etc.

Note that not all properties that are addressed as “Courtenay” are located within the City of Courtenay Municipal Area. If unsure admin staff will be happy to confirm for you. You may also visit the CVRD’s Imap to check if your property is located within Electoral Area B, click on the link here:

<https://mapviewer.imaptoo.ca/secure/>. You can search by address and then click on the property when the map zooms into the area. An information pop up window will open as shown in the example below and will display the Electoral Area for you.

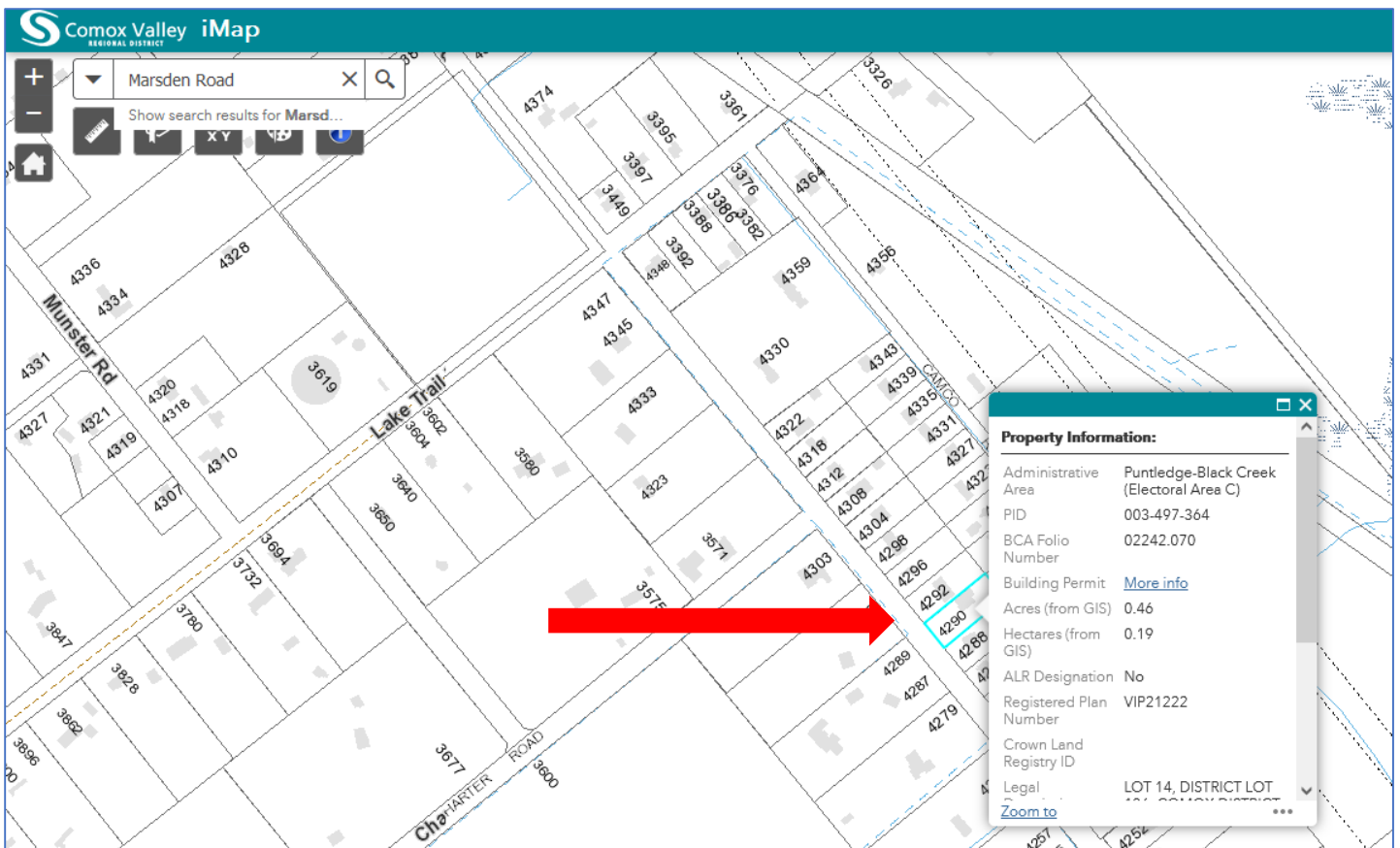

830 Cliffe Avenue
 Courtenay BC, V9N 2J7
 250-334-4441
 250-334-4241 Fax

CITY OF COURTENAY
CEMETERY MANAGEMENT AMENDMENT BYLAW NO. 2772
SCHEDULE 'B'

RESIDENT FEES (\$)

Ground Burial	Grave Space	Care Fund Contribution	Preparation & Placement	TOTAL	Grave Space Only
Casket Lot	474.00	158.00	1215.00	1847.00	632.00
Casket Lot Section 'U'	549.00	183.00	1215.00	1947.00	732.00
Child Lot Section 'Q'	225.00	75.00	700.00	1000.00	300.00
Infant Lot Section 'Q'	131.25	43.75	285.00	460.00	175.00
Cremation Lot	225.00	75.00	285.00	585.00	300.00
Additional Cremated Remains Interment Right into an existing casket burial		75.00	285.00	360.00	
Scattering			120.00	120.00	
Columbarium	Niche Space	Care Fund Contribution	Preparation & Placement	TOTAL	Niche Space Only
Double Niche 1st Interment	900.00	100.00	100.00	1100.00	1000.00
Double Niche 2nd Interment			100.00	100.00	
Bottom Row	720.00	80.00	100.00	900.00	800.00

NON-RESIDENT FEES (\$)

Ground Burial	Grave Space	Care Fund Contribution	Preparation & Placement	TOTAL	Grave Space Only
Casket Lot	780.00	260.00	1215.00	2255.00	1040.00
Casket Lot Section 'U'	855.00	285.00	1215.00	2355.00	1140.00
Child Lot Section 'Q'	315.00	105.00	700.00	1120.00	420.00
Infant Lot Section 'Q'	246.00	82.00	285.00	585.00	300.00
Cremation Lot	315.00	105.00	285.00	705.00	420.00
Additional Cremated Remains Interment Right into an existing casket burial		105.00	285.00	390.00	
Scattering			220.00	220.00	

Columbarium	Niche Space	Care Fund Contribution	Preparation & Placement	TOTAL	Niche Space Only
Double Niche 1st Interment	1620.00	180.00	100.00	1900.00	1800.00
Double Niche 2nd Interment			100.00	100.00	
Bottom Row	1440.00	160.00	100.00	1700.00	1600.00

Memorials

Ground Marker Setting Fee		Setting Fee	Maintenance Care Fund	TOTAL
Initial Placement		140.00	10.00	150.00
Resetting Fee		40.00	10.00	50.00
Columbarium Bronze Memorials (includes installation)		Memorial	Maintenance Care Fund	TOTAL
Columbaria Bronze Niche Plate		465.00	10.00	475.00
Columbaria Bronze Second Name Scroll		115.00	10.00	125.00
3" x 4" Bronze Memorial on Scattering Board		240.00	10.00	250.00
Memorial Boulder includes 4" x 6" bronze plaque	RESIDENT	790.00	10.00	800.00
	NON RESIDENT	1590.00	10.00	1600.00
➤ Second plaque		290.00	10.00	300.00

Administration Fees

Late Arrivals at Cemetery (to be charged to funeral home for each half hour, or part thereof, after scheduled arrival time)	50.00
Licence Transfer Fee	20.00

Monday-Friday after 3:30 p.m. Add \$250.00 to the Preparation and Placement Fee

Saturday, Sunday and Statutory Holidays	Full Burial	Preparation and Placement Fee \$1,500.00
	Child Burial	Preparation and Placement Fee \$892.00
	Infant Burial	Preparation and Placement Fee \$427.00
	Cremation	Preparation and Placement Fee \$427.00
	Niche	Preparation and Placement Fee \$150.00

Exhumation Casket Lot	1600.00
Exhumation Cremation Lot	425.00
Exhumation Infant	425.00
Exhumation Child Lot	1000.00
Exhumation Niche Space	125.00

Tent Set-up 125.00

Second Flower Container 34.00

Other Fees:
Cemetery products not listed Cost + 50%

All fees are subject to applicable taxes.